



Staffan TW



To secure that the walking-aid will function safely for the user, once per year review of the walking-aid should be done. Therefore is the following interventions recommended.

☐ **Cleaning**

When cleaning the walker it is recommended machine washing, 60 degrees for 10 minutes. When using a pressure washer, do not wash directly to the bearings. In addition to machine washing, regular cleaning with a mild cleanser is recommended. **Note!** Do NOT use thinner, petrol or other solvents.

☐ **Post treatment**

After washing, all connections, tight spaces and drainage holes should be blown dry and sprayed with thin oil. If degreaser is used, should the moving parts be lubricated.

☐ **The Paint**

Control damages to the paint. To prevent corrosion, improve scratches. Touch-up paint can be ordered from Human Care HC AB.

☐ **Pipe frame**

Control weldings and screw attaches. If the corrosion is extensive shall the rollator be replaced.



☐ **Handle**

Must be fixed. Make sure the handle pipes can be pushed down to the chassis. Change the grip if needed.

☐ **Brakes**

Control that both brakes and parkingbrakes are working. Wires should be intact and strapped to the chassis.

☐ **Wing nut**

Control function.

☐ **CE-marking**

Make sure that the CE-marking is still there and readable.

☐ **Wheels**

Make sure the wheels are not worn-out and are spinning easily without any noise.

☐ **Lubrication**

The front forks shall function without noise, lubricate when needed.

☐ **Front forks**

Make sure that the forks swings easily.



☐ **Stability**

Control that all wheels are steadily on the ground and that there are no chassis distortion.

☐ **Test driving**

Make a final control by test driving.

Note!

Recondition must be done by a person who has good knowledge about how the job should be performed. An incorrectly performed recondition could result in an accident/incident. Don't hesitate to contact your retailer if questions come up.

When exchanging parts of the trolley walker, use only Human Care parts to ensure continued CE-validation.

When disassembling of a wheel, the wheel nut and pin bolt must be replaced since they contain a self-locking that will be destroyed when disassembling.

If the corrosion is more than a film of rust the trolley walker shall be discarded and return for recycling.

Intended use

The trolley walker should only be used as support whilst walking. Do not alter the trolley walker yourself.

Product number:
Owner:
Notes:
Attended by:
Place and date:

Spareparts list

No	Designation	Quantity	Art. no	Other information
1	Rear fork right complete	1	400-019H	<i>Pin bolt and wheel nut must be exchanged when disassemble the fork.</i>
2	Rear fork left complete	1	400-019V	<i>Pin bolt and wheel nut must be exchanged when disassemble the fork.</i>
3	Front fork	2	200-006	<i>Pin bolt and wheel nut must be exchanged when disassemble the fork.</i>
4	Cover lid	2	20-014	
5	Wheel kit	4	89015	<i>Pin bolt and wheel nut must be exchanged when disassemble the wheel</i>
6	Wheel with bearing	4		
7	Pin bolt	4		
8	Wheel nut	4		
9	Brake	2	10-013	
10	Pop nut-brake	2	000139	
11	Starlock-D6	6	00113	
12	Brake spring	2	00131	
13	Adjustment screw	2	10-010	
14	Wire lock	2	10-017	
15	Wing nut complete	4	50937	<i>Lubricate the wing nut when needed.</i>
16	Wing nut	4		
17	Screw	4		
18	Washer	4		
19	RA handle	2	20-064	
20	Handle brake complete	2	10650	<i>Complete with housing, brake handle and pop nut.</i>
21	Handle	2	00020	
22	Walking table-cushion	1	20-053	
23	Cushion bracket left	1	400-026H	<i>Staffan TW low</i>
24	Cushion bracket right	1	400-023H	<i>Staffan TW high</i>
25	Cushion bracket left	1	400-026V	<i>Staffan TW low</i>
26	Cushion bracket right	1	400-023V	<i>Staffan TW high</i>
27	Handle pipe	1	400-025	<i>Staffan TW low</i>
28	Housing	2	00013	<i>Staffan TW low</i>
29	Housing	2	00014	<i>Staffan TW high</i>
30	Wire	2	00005	<i>Staffan TW low</i>
31	Wire	2	00003	<i>Staffan TW high</i>

RECONDITIONING MANUAL

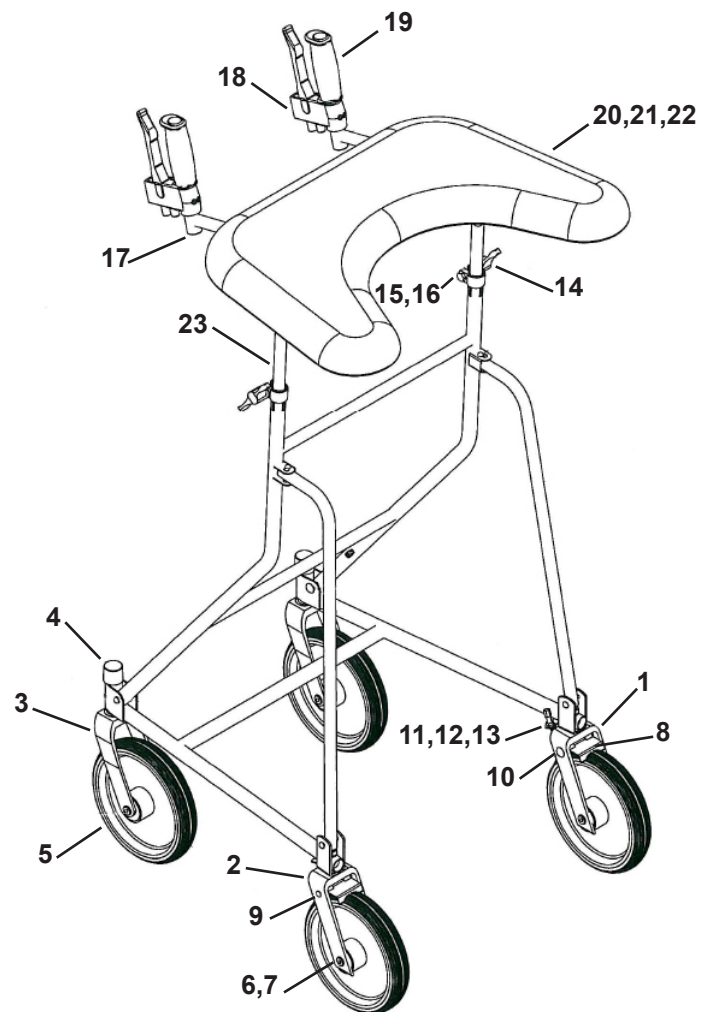

• Årstaängsvägen 21C, SE-117 43 Stockholm, Sweden •
• Tel. +46(0)8 - 510 132 00 • Fax +46(0)8 - 665 35 10 •
• www.humancaregroup.com •