

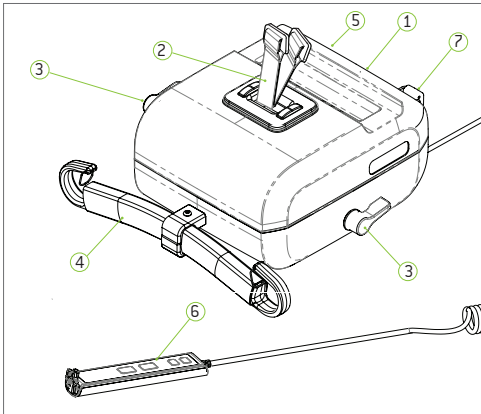

**Important!** This quick reference guide does not replace the user manual which can be downloaded at [www.humancaregroup.com](http://www.humancaregroup.com).  
**Read all instructions before use!**

## Components



- 1 Secondary Panel    4 Hanger Bar    6 Hand Control
- 2 Lift Belts        5 Emergency Stop    7 Leg Hook
- 3 Direction Levers

## Secondary Panel Functions

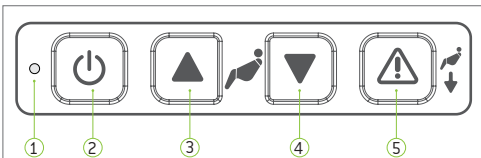

- 1 Status Indicator Light    4 Lower Lift
- 2 Power On/Off            5 Emergency Lowering
- 3 Raise Lift

## Status Indicator Lights

- Flashing Green**  
On/Ready for Use  
Full Battery
- Flashing Yellow**  
On/Ready for Use  
Battery Level Normal
- Flashing Red**  
On/Ready for Use  
Low Battery  
Charge Battery Warning
- Constant Green**  
Lift in Use
- Constant Red**  
Safety Catch Engaged  
Troubleshooting!
- Constant Yellow**  
Lift Charging  
Functions Blocked
- Flashing Green/Yellow**  
Service Warning  
Perform Inspection
- Flashing Red/Yellow**  
Service Passed  
Battery Low



**Important!** This overhead lift has been designed and tested for indoor use with one patient at a time. This product must not be immersed in water.  
**Read all instructions for full product information!**

## Hand Control Functions

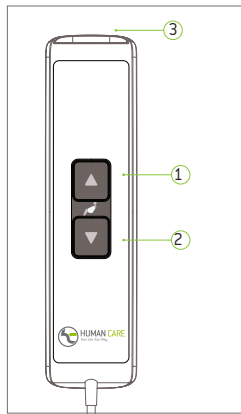

- 1 Up Button
- 2 Down Button
- 3 USB and Charge Port



**Important!**

The covers for the USB input and the charging input [3] must be closed for the hand control's water protection (IPX5) to be valid.

## Charging the Lift

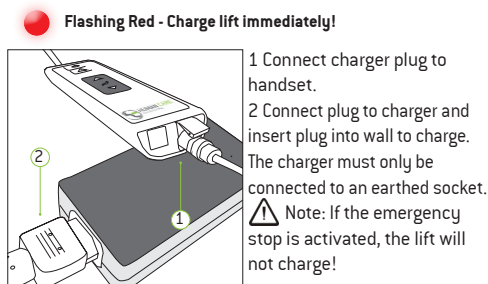

**⚠ Important! The lift can only be used with a Human Care charger and must be disconnected to use the lift.**

Models: 55300  
Human Care HC AB. All Rights Reserved.



## Room to Room Transfer Feature

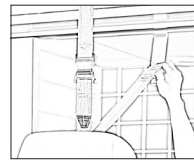

**Room to room transfers**  
Activate desired belt by turning directional lever. If lever faces towards the leg hook, the belt nearest to the leg hook is active. If it faces towards the hanger bar, the belt closest to the hanger bar is active.



**Important! Do not turn the lever unless both belts are connected to their respective rail rollers. The lever must always point to the connected belt.**

## Using the Lift

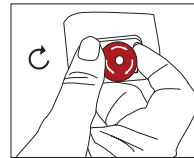

**Emergency Stop Activation**  
Press down on red button to activate.

**Emergency De-Activation**  
Turn red button clockwise.



**Important! Emergency lowering must only be used in emergency situations. There will be a 3 second delay.**



To activate, press "Down" button [4] and secondary panel emergency lowering button [5] at the same time.

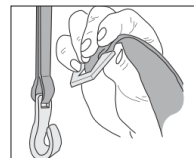

**Suspending the lift**  
Place the lift on a suitable surface and feed out belt by gently pulling out belt while at the same time pressing the "Down" button on either the hand control or secondary panel. Hook lift belt onto distance strap so that it is held firmly in position (easiest to hook from above at an angle as shown). **Ensure the lift belt is firmly in place before use.**



**Slings**  
Attach head sling loops to hanger bar first, then leg straps to leg hooks. Ensure the straps are secured beneath the safety pin.



**Proper lifting techniques**  
Do not use the hanger bar to move the patient and the lift. Do not hold onto the hooks while performing a lift. Once the patient is comfortably secured in sling, raise lift, hold sling and position/move patient.

## General Care



Charge lift every night.



Disinfect with DuPont™ Virkon®.



Do not immerse in water.



Wipe down with slightly dampened drying cloth.



Never use strong detergents on lift.



Activate emergency stop when not in use.



**Important! Use only authorized methods to transport!** Lift must always be stored or moved in horizontal position. Rest on cart to move or use approved carry strap<sup>1</sup>.  
<sup>1</sup> Caution! When using strap, extra caution must be taken not to wrinkle or bend the lift belt.

## Inspection

**Annual Inspection** - The lift must be inspected at least once per year by a qualified technician certified by Human Care. Replace lift belt at a minimum every second year as a preventative action.

**Monthly Inspection** - Check lift belts for damage or wear. Feed entire length to ensure proper functioning.

**Daily Inspection** - Always inspect the lift for visible signs of damage before use. Ensure the lift is correctly mounted on the distance strap or rail roller. Always check slings and belts for signs of wear before use. Do not use if wear evident.

## Troubleshooting

- If the indicator light is not on, check the following:**
  - Mains switch is on
  - Batteries are fully discharged - charge or replace
  - Emergency stop button is not pushed in (deactivate by turning clockwise)
- If the indicator light is flashing, check the following:**
  - Hand control button does not function up/down when depressed (replace if necessary)
  - When pressing up, the lift is not already in its maximum upper position (lower with down button)
  - When pressing down, the lift is not already in its maximum lower position (raise with up button)
- If the indicator light is constant red:**
  - The lift motor is overheated - allow to cool
  - The lift is overloaded - lower using emergency lowering button
- If the indicator light is constant yellow:**
  - Charging in progress
- If the lift belt does not feed out properly:**
  - Pull the belt upwards at the same time as you depress the down button on the hand control / lift panel
- If the indicator changes to flashing red:**
  - The batteries need charging, patient may be lifted a few more times